

INFRASTRUCTURE UPDATE

PHASE 2 GREEN INFRASTRUCTURE PROJECT: EAST HIGH SCHOOL

CONSTRUCTION SCHEDULED FOR: MARCH 2019 – DECEMBER 2019

KC Water is undertaking a green infrastructure project at East High School. This project uses natural solutions consisting of green infrastructure elements, including three retention basins. These elements will collect, treat and infiltrate stormwater runoff. When complete, the project will help protect our community's environment by capturing stormwater before it enters the combined sewer system, lessening the frequency of sewer overflows into local waterways.

PROJECT AREA

THIS PROJECT IS LOCATED ON THE EAST HIGH SCHOOL CAMPUS. THE BOUNDARIES ARE:

- NORTH: E. 17TH STREET
- SOUTH: E. 20TH STREET
- EAST: VAN BRUNT BOULEVARD
- WEST: BRIGHTON AVENUE

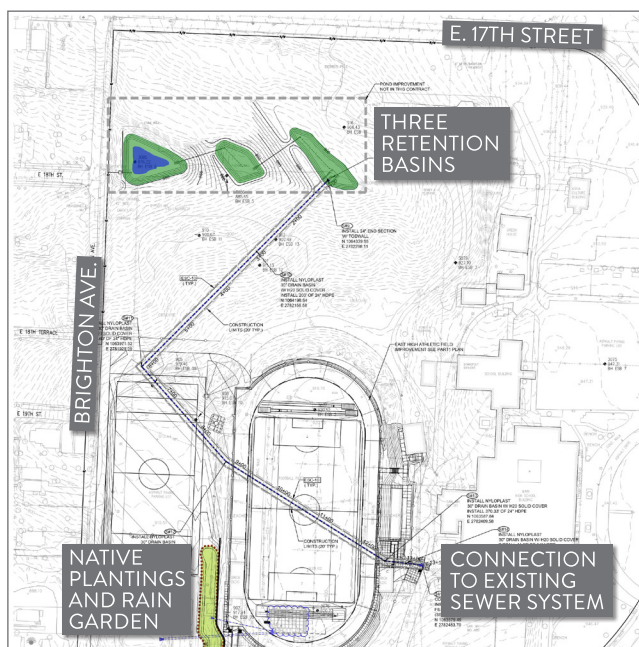

QUESTIONS?

TO LEARN MORE, PLEASE CONTACT:

DIANA JOHNSON

Project Manager
KC Water

(816) 513-0376

Diana.M.Johnson@kcmo.org

SCOTT SCHULTE

Design Professional
Vireo

(816) 777-3039

scott@bevireo.com

JOHN WRIGHT

Construction Contractor
Pyramid Excavation & Construction, Inc.

(816) 765-4464

jwright@pyramidexcavation.com



PHASE 2 GREEN INFRASTRUCTURE PROJECT: EAST HIGH SCHOOL

WHAT'S BEING DONE?

For this project, KC Water plans to construct:

- Three retention basins designed to hold additional water during rainfall events
- Hydraulic control structures and piping to connect the basins
- An outlet connection to the existing combined sewer system
- Native plantings in and around the basins and existing rain garden

WHAT'S THE TIMELINE?

Construction began in March 2019 and is expected to end in December 2019.

WHAT CAN YOU EXPECT?

We appreciate your support and patience as we work to complete this important community project. Customers will be notified in advance of pending disruptions, which may include:

- Large equipment creating noise and dusty conditions
- Temporary street and lane closures

WHO'S DOING THE WORK?

KC Water will be assisted by its program manager, Burns & McDonnell; its design professional, Vireo; and its construction contractor, Pyramid Excavation & Construction, Inc.

WHAT'S THE CONTRACT AMOUNT?

The budget for Phase II of construction is \$569,031.60.

WHAT'S THE "CONSENT DECREE"?

In 2010, the City of Kansas City, Missouri entered into a federal Consent Decree with the United States Environmental Protection Agency to reduce the volume and frequency of overflows from the City's sewer system. KC Water's Smart Sewer program is a 25-year plan to address this challenge. The East High School Green Infrastructure Project is one piece of the Smart Sewer program.